



# RETINO ISLE750

- » Ready for 750mm square ceiling systems
- » Eliminates need for pre-cut ceiling tiles
- » Patented adjustability
- » Coffered back reflector
- » Feature Isle gondola



## Unique

The Retino Isle750 was designed with input from an architect and from their point of view. It offers consultants and architects the opportunity to specify an interesting alternative to pre-prepared aperture luminaires in 750mm square ceiling systems and instead completely replaces a 750mm ceiling tile. This allows for easy on site installation and cost savings on preparing special ceiling tiles.

In addition to creating a sense of height in any open plan office with its coffered back reflectors, the Retino Isle750 also includes our patented adjustable gondola system, which means that the central floating Isle gondola can be easily moved to its dropped position, helping with LG7 compliance in the area.

Our flexible manufacturing allows us to be able to adapt and design additional features such as differing reflector rolls or project specific colours and textured finishes.

The Retino Isle750 is an aesthetically pleasing yet efficient luminaire.

## Features

### LIGHTING

- » High LOR (77%)
- » ECA compliance
- » Assists with LG7 compliance
- » LG3 brightness control

### ARCHITECTURAL

- » Coffered design gives a sense of depth to the room
- » Isle gondola creates interest with its floating halo effect
- » Adjustability allows for clean ceiling lines yet near LG7 compliance

### COMMERCIAL

- » Fully replaces a 750 x 750mm ceiling tile, a cost effective alternative to pre-prepared aperture luminaires
- » Meets the requirements of the Enhanced Capital Allowances Scheme.

## Design

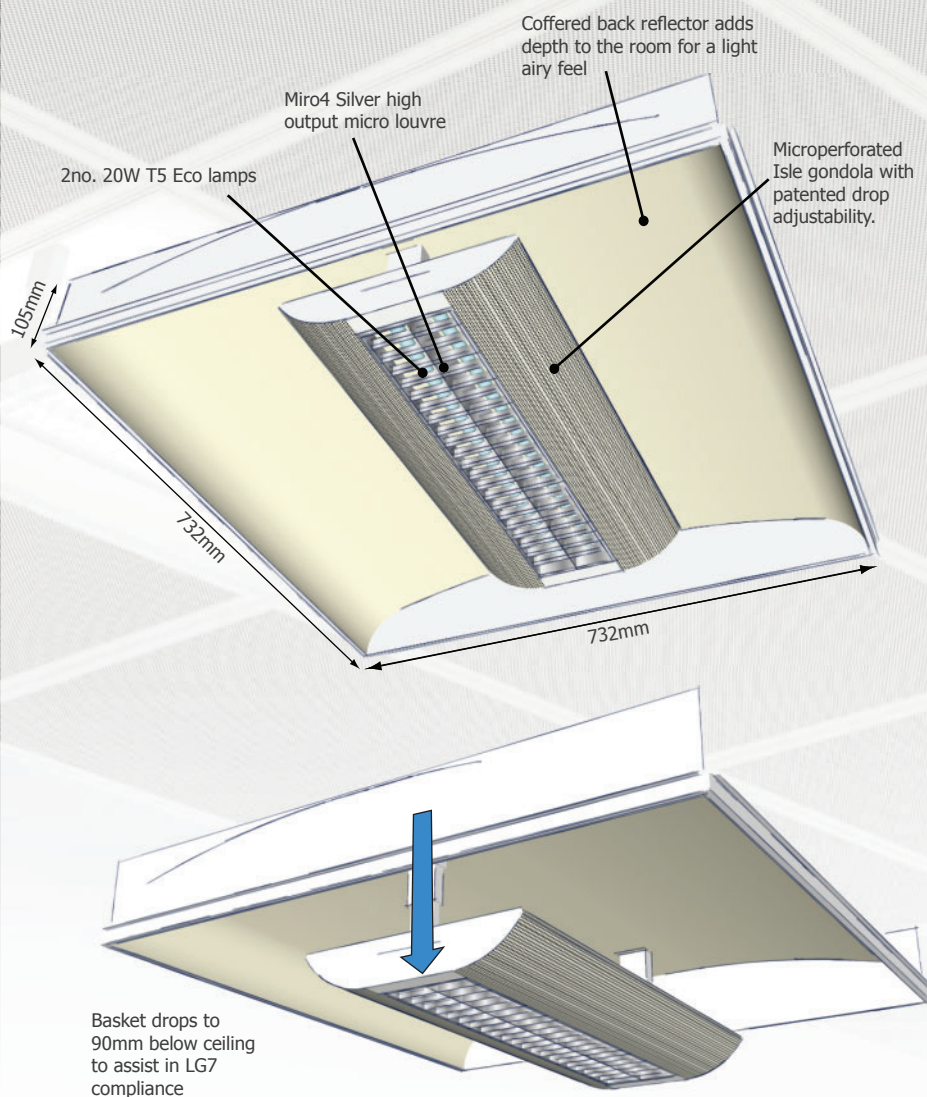

Polar curve in Recessed Position

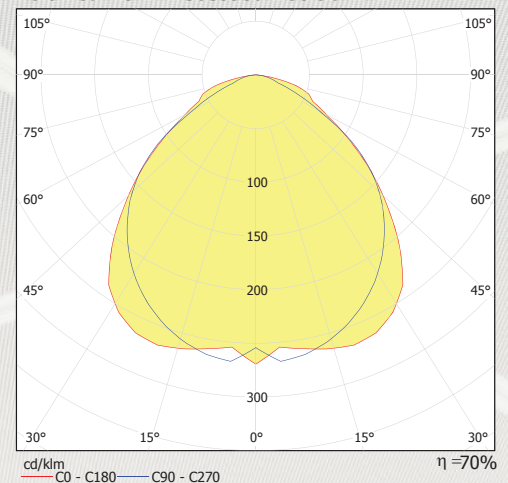

Polar curve in Lowered Position

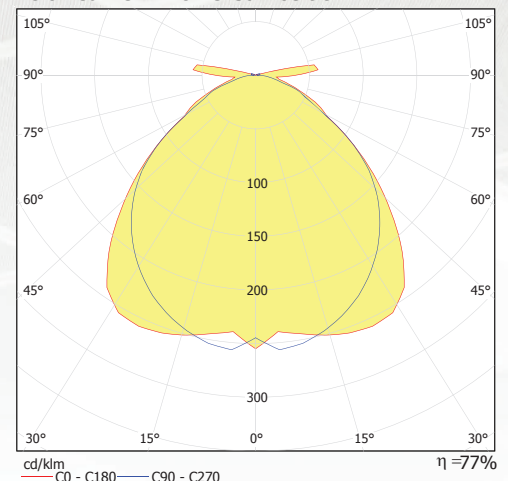



## Ceiling Integration

The RET Isle750 is compatible with most commercial ceiling systems including those shown here.

If the project ceiling system is not shown here, please contact our technical department for further advice.

\*Products for these ceiling systems will require external brackets (Ref: /BKTS)

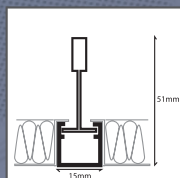

Alugrid-P 15/16

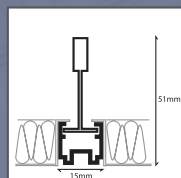

Alugrid-Q 15/16

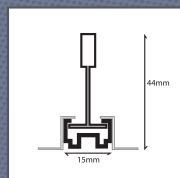

Alugrid-Q 15/08

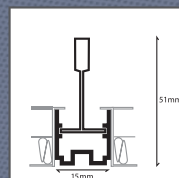

Alugrid-Q 15/19

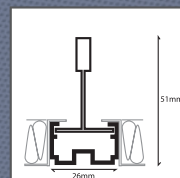

Alugrid-Q 26/16

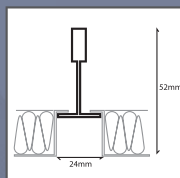

\*TruGrid T24 System

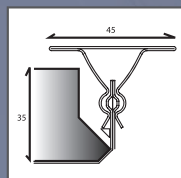

\*Burgess "Spring Tee" or Orcal Spring Tee.

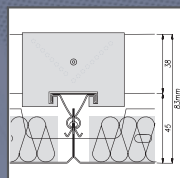

\*System 120 Long Span Spring Tee

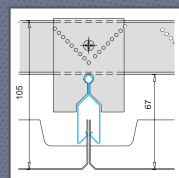

\*SAS 150

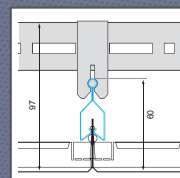

\*Armstrong Orcal Clip-in

## Detail

### Miro4 Silver® Louvre

Alanod Miro4 Silver® has a **total reflectivity of 98%** with **no colour spectrum shift** which ensures the fitting is highly efficient with good colour rendering.

### Adjustability

Our **patented** (GB2442072) **adjustable** gondola allows for the luminaire to be fully recessed for **clean ceiling lines** or dropped to a semi-recessed position to assist in **LG7 compliance**. This can be done **easily** without having to remove the luminaire from the ceiling and without any special tools.

### Lamps

Phillips T5 Eco lamps provide a **10% energy saving** over traditional T5 lamps. T5 Eco lamps are available in colour 830 or 840. This luminaire requires 2no. 20W T5 Eco lamps. Optionally a higher output version is available with a 55W PLL lamp if required.

### Integrated controls

The louvre of the Retino Isle750 can incorporate the Phillips Actilume sensor.



### Microprism Optic

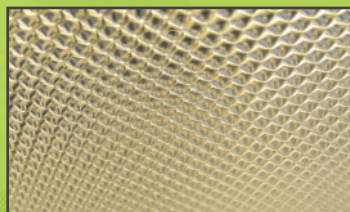

Optionally, the central louvre can be replaced with a microprism controller. This uses conical de-glaring prism technology for a high **92% transmission** whilst keeping brightness levels to a minimum.

### Efficacy & Compliance

With an **LOR of 77%** and consumed circuit power of 43W, the luminaire achieves an efficacy of **62.6LL/CW**, exceeding both **Part L** (Building Regs) and **ECA** requirements.

### Materials and Finishes

The luminaire body is manufactured from **high grade steel**, tabbed and welded to ensure rigid construction and post painted to RAL9016, 20% gloss. Optionally the luminaire can be finished to any other commercially available RAL colour and textured finishes, such as Finetex.

### Ballasts

We only use **high quality** high frequency ballasts from **industry leading** manufacturers, including Philips, Tridonic & Helvar.

## Specification

Standard product reference:

**RET/ISL75/220/HF/W2R**

For any optional extras, please suffix the appropriate reference as detailed below:

Lamps	Reference
- 2 x 20W T5 Eco	(as standard) /220
- 1 x 55W PLL	/155*

\*55W lamp option changes the style and technical properties of the luminaire slightly. Please enquire for further details if required.

Ballast	Reference
- HF Fixed Output	(as standard) /HF
- DALI dimming	/HFDAL
- Digital dimming	/HFDIG
- 1-10V dimming	/HFDIM

Air Handling	Reference
- 20ltrs/sec	/AH20
- 40ltrs/sec	/AH40*

\*40ltrs/sec can only be achieved through visible slots on the front face of the body. 20 litre option can be either on front face or back body, please confirm when ordering.

Central Optics	Reference
- Miro4 Silver louvre	(as standard) /W2R
- Microprism diffuser	/MPK

RAL Colour	Reference
- 9016 20% Gloss	(as standard)*
- 9010 20% Gloss	/9010

\*It is the purchaser's responsibility to ensure that the standard colour we supply meets their requirements.

Maintained Emergency	Reference
- 3hr (unmonitored)	/3M
- 3hr DALI monitored	/3MPRO

Reference Example:

**RET/ISL75/220/HFDAL/W2R/AH20/3M**

Would denote a RET Isle750 with 2x20W T5 Eco lamps, HF DALI dimming ballast, Miro4 Silver louvre, 20ltrs/sec return air handling and 3 hour emergency kit (not monitored or self-test).



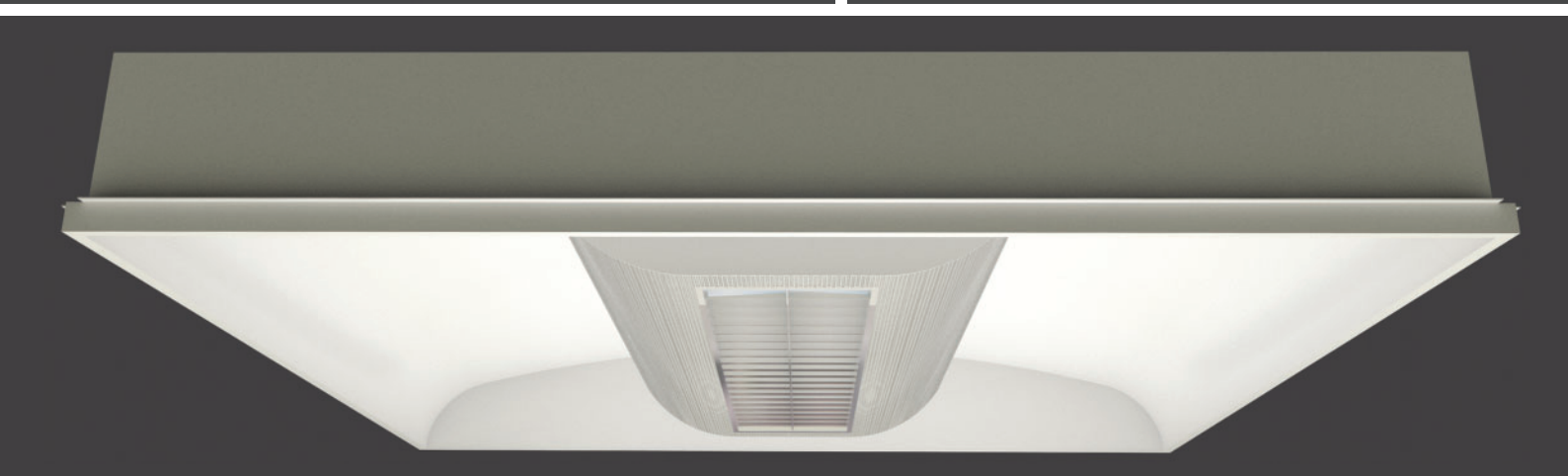

Lumitron Lighting (Services) Ltd  
Unit 31 The Metro Centre, Tolpits Lane, Watford, Herts, WD18 9UD  
T: 01923 226 222 - F: 01923 211 300 - sales@lumitron.co.uk